

Waratah-Wynyard Council and Sisters Beach Wildcare Community Group are planning a revegetation project just south of the Sisters Creek Estuary. Council and Wildcare would like your opinion on this proposal, offering any ideas you have for improvement.

REPURPOSING THE OLD PLAYGROUND PROPOSAL

The playground equipment located south of the Sisters Creek Estuary is in a low-lying area that is inundated with water during the highest tides. This equipment is becoming eroded. Council has determined that it is at the end of its useful life and needs to be removed.

To replace this older playground, new equipment is being planned for the other larger play area at Sisters Beach, located east of the car park. This playground is on higher ground and is next to the new Recreation Park. The aim will be to create an expanded safe and fun family area on this higher ground that is at a reduced risk of flooding.

The proposal for re-purposing the old playground area is to build a nature trail that meanders through the site, with connecting paths that will provide picnic, seating and open grassy areas for the community and visitors. All plants used will be local to the area. The seating and table area will be on a purpose-built raised mound, so that these are protected during flooding. This raised area will be exposed to full sunlight, with only low plants in front. It will offer a reflection space that has views across the estuary, the beach, and the ocean beyond.

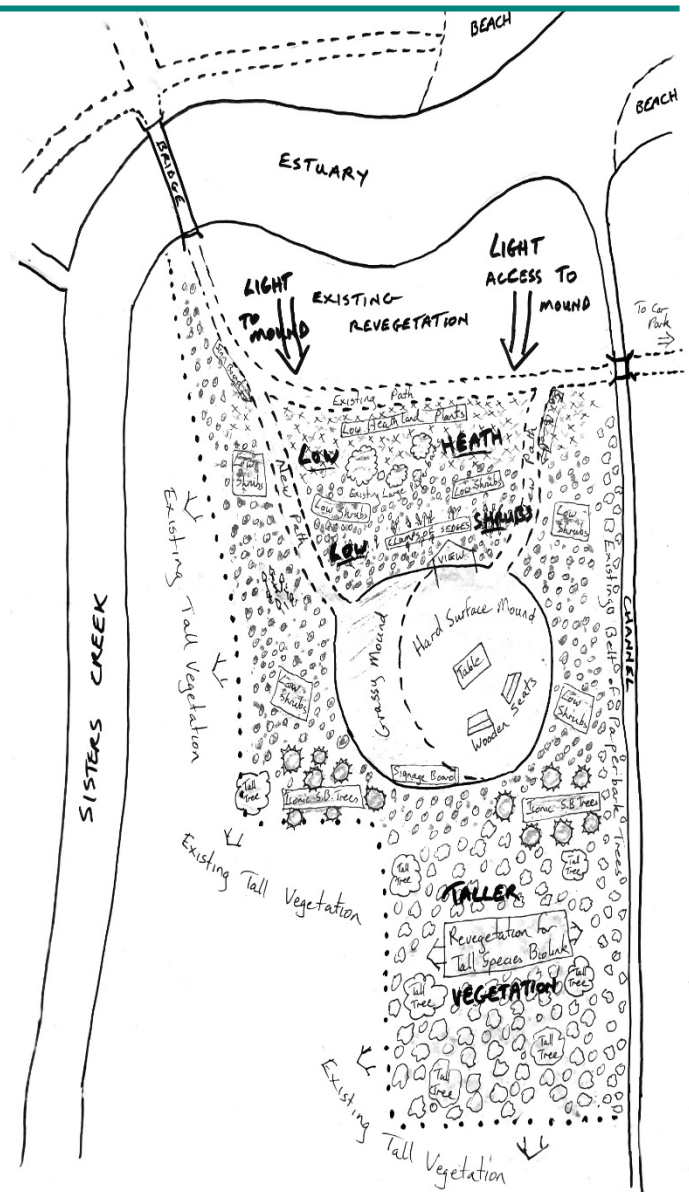

The above diagram is indicative only and subject to change. Whilst the proposal provides a vision for the area, it is not a commitment to undertake works immediately. Council will consider the timing and funding of works and may alter the order and timing of the works.

To have your say, please contact Rebecca Billing at Waratah-Wynyard Council on 03 6443 8333 or rbilling@warwyn@tas.gov.au by Friday 17 September, 2021.